

INSTALLATION GUIDE

Modern Rhomb 170

Product Technical Information

Wood: Local spruce or pine

Thickness: 30mm

Sides: 4 sides 30 degree

Size: 170 x 170mm (visible), 186 x 186mm (full)

Seam: 7mm

Substructure: 50 x 25mm (vertical) every 125mm

(8m/m², 0.01m³/m²)

Fixation holes: Pre-drilled 2pc 4mm holes on top side

Fixation: 2 wood screws 4x40mm per shingle (65 screws/m²)

Montage speed: 2.5m²/h

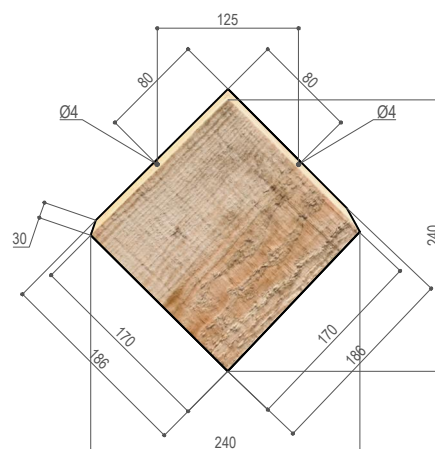

Picture 1. Modern Rhomb 170 dimensions.

Sub-structure

Vertical substructure should be used as final montage layer before the installation of Modern Rhomb shingles. Suggested dimensions of substructure are 50x25mm every 125mm. Under the vertical substructure - traditional layers of ventilated facade can be used both for timber frame as well as masonry and other type of buildings. For best visual view - substructure and wind barrier should be black/dark to reduce their visibility through the seams of Modern Shingle facade.

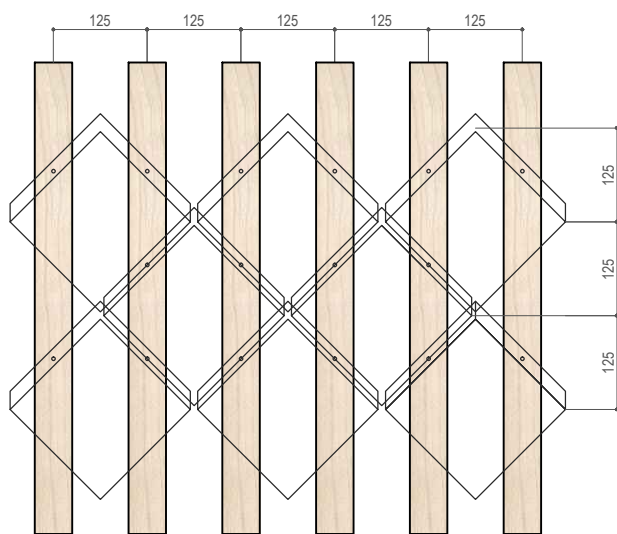

Picture 2. Substructure front view.

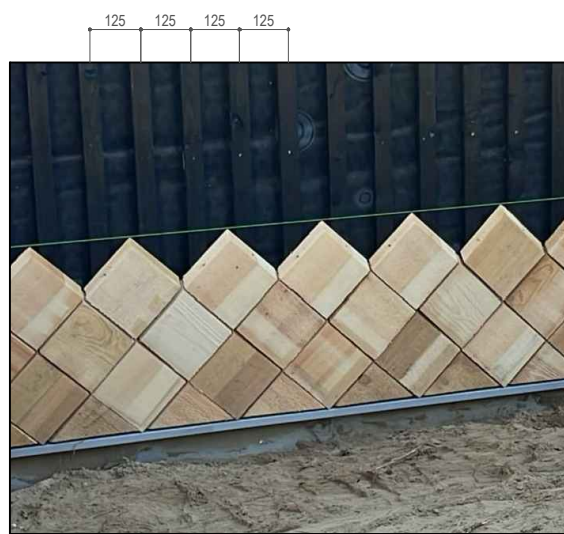

Picture 3. Substructure photo.

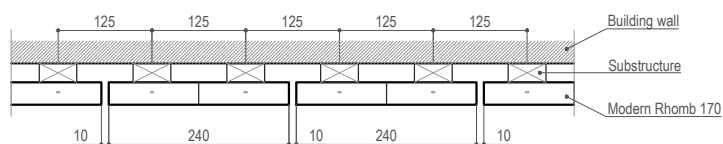

Picture 4. Substructure top view.

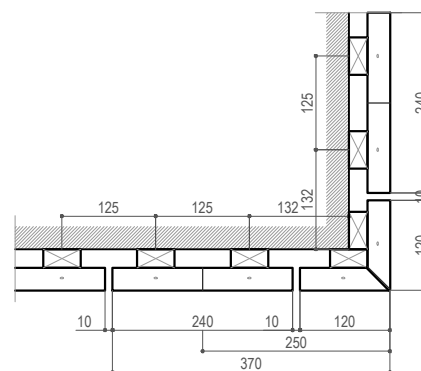

Picture 5. Substructure corner.